

Learn basics, expand your creativity.

Mold

You can make delicate pattern ring with Art Clay exclusive mold

Designed Silver Ring



F-1005
Art Clay Exclusive mold Ring (Medium)

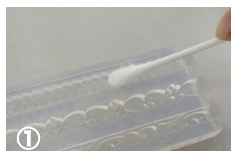

Coat thin layer of oil in the mold design, so you can easily take out of the mold.



Roll the clay to a rope shape and adjust the size and width to fit your chosen design.



Push the clay in the mold. Make sure the clay buried well by checking from the back of the mold.

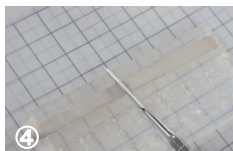

Moisten the clay surface a little and rubbing off excess clay with a burnisher

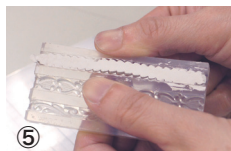

Take the clay out from the edge slowly by bending the mold.

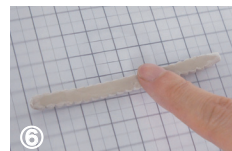

Moisten side of the clay where will be inside of the ring.



Lap the clay around a wooden mandrel and join the edges with Art Clay Paste type. Dry.

Openwork Pendant charm



F-1395
Art Clay Exclusive part mold (Leaf)



Coat thin layer of oil in the mold design, so you can easily take out of the mold.

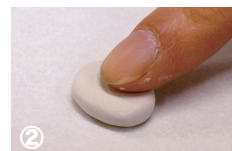

Roll the clay to a ball shape, then flatten to oval shape.



Push the clay from center to the edge. Make sure no air kept between the mold and the clay.



Moisten the surface



Rubbing off excess clay with a burnisher.



After drying the piece, smooth exposed surface with sponge sanding pad (Red).

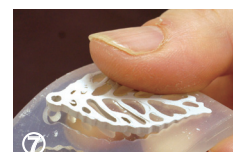

Take the piece out slowly by bending the mold. Please be noted dried clay is fragile.



This is used when cutting glass. It can be used for mold-releasing agent as well.

R-0070
Cutting oil
Volume/100ml

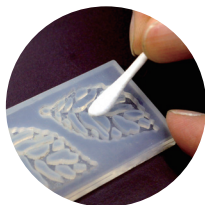

Convenient to moist the clay. It has water tank in the grip part. The water is soaked gradually to the pen tip without squeezing the tank.



F-0133
Moisturizing pen
Length/150mm



UV resin UV resin Technique

UV resin crystal is fast curing and has high transparency. It is easy to combine/attach with finished Art Clay Silver work. It can be cured so quickly in UV crystal lamp box and can also decorate many other different craft materials. You can make own transparent color by adding pigment.



R-0912
UV Crystal Lamp Box



R-0618
UV resin crystal (25g)



R-0910
UV resin crystal (50g)



How to add color



①
Pour UV resin crystal on a Paper palette.

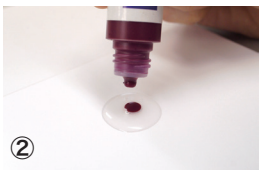

②
A few drop of UV color pigment on UV crystal resin.



③
Mix with a palette knife.



④
If you find a bubble in the resin, get rid of it with flame of lighter.



⑤
Scoop up the colored crystal resin with toothpick or palette knife and put on your work.



R-0177
Paper palette
Size / 100x148mm 30 sheets
For mixing UV resin crystal and UV resin pigment.



I-0020
Palette knife
Used to pick and mixing UV resin crystal and UV pigment.

Make your own resin charm with gemstone and dried flower.

Using silver ribbon wire & Blue mix

Crystal Pendant

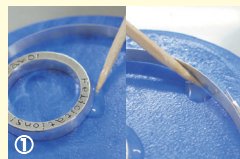

①
Place Silver ring and silver ribbon wire on cured Blue Mix. Fix all parts with UV resin and cure for 5 mins.

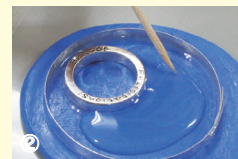

②
Pour UV resin inside the wire about 1/3 level.



③
Place a pressed flower in the resin and cure it for 5 mins. Cover another resin layer, and add another flower.



④
After placing all inclusions, pour UV resin as same level as the ring.



⑤
After curing, take out the resin from silver wire and Blue Mix.



⑥
Make thin layer of UV resin on the back and cure it.

UV resin in silver frame.

Silver Anklet



①
Seal the bottom of the finished silver frame with a sticktape to hold UV resin.



②
Turn it over and pour UV resin to make first layer in about 1 mm thick.



③
After curing the resin for 2 mins with the UV lamp, put some dried flower in the resin.

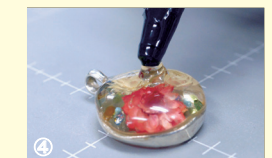

④
Pour UV crystal resin again and cure for 2 mins with the UV lamp. Repeat this step for 2~3 times to build up.



⑤
Put thin layer of UV crystal resin on the back and cure it to finish. Now, it is ready to wear.



Rotary tool Increase efficiency & quality of your work



Rotary tool is an electrical motor tool, often used for metalsmithing. This helps to file, polish and finish your work in more efficient and faster way.

F-0924W ♦ Handy Rotary Tool (POP File/Pearl White).



Variable speed control of the rotation.

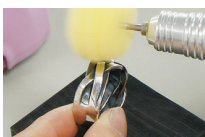

Torque is strong, so you can keep working even in a low rotation speed.



Comes with a foot pedal that you can turn on and off.

Point How to finish with rotary tool

1. After polish your work with a stainless steel brush.

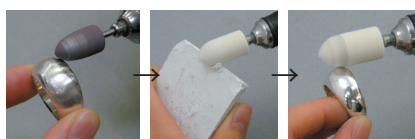

Firstly, smooth entire piece with rubber point. Then, add some polishing compound (#4000) on finishing point before mirror finish.

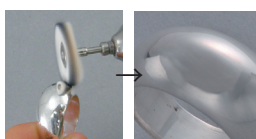

Apply some Blue luster compound(#6000) on Cotton buffing wheel. Polish it for mirror finish.

2. In case you find a big scratch...

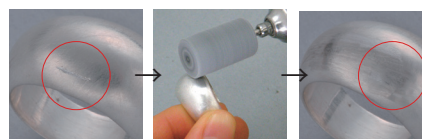

When you find a deep scratch, polish with whetstone point (#120) or rubber point (#120) until the scratch is removed. Then do the step 1.

◆ Rubber points

Rubber point is used for pre-finish after the piece has been fired. You can make very fine surface with #320 rubber point, and it will be ready to make mirror finish with finishing points.



Middle finish

Smooth the silver surface after polish with stainless brush



Final finish

For mirror finish & surface gloss



◆ Whetstone Points

It is convenient tool to polish inside of ring. No dust stuck and make a beautiful finish work.

F-1226 Whetstone Points set
(F-0074 · F-1009 · F-1011 · F-1014 · F-1015)

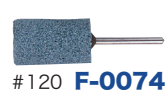

◆ Finishing points

These points are to polish the piece for mirror finish. Choose the points depending on the shape and size of your work.



F-1227 Finishing point 5pcs/pckt
(F-0086 · F-0087 · F-0089 · F-0090 · F-0939)

Cleaning the points

Once the finishing points get dirty, the surface can be cleaned by rotating it on diamond sanding mat #80 (F-1016). Make sure to clean the point, otherwise, mirror finish cannot be made.

Mirror finish

Use with polishing compound



Gloss finish

Use with Blue Luster



※This point (F-0939) requires no compound.

◆ Polishing material

Apply these compounds on Felt point or Cotton thread wheel for mirror finish.



◆ Radial Bristle Discs

Good to polish for a narrow gap or a part where syringe is used. Polish from Yellow → Brown → Blue → Pink → Orange → Green. Lastly, finish with Cotton buff point.

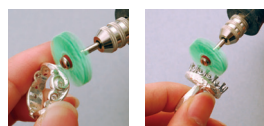

Coarse finish

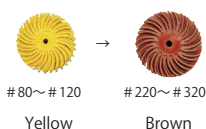

Middle finish

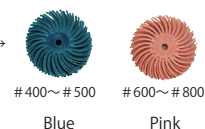

Final finish

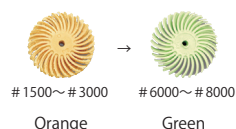

F-0119 Radial Bristle Discs assortment 6pcs/pckt
(F-0120~F-0125) (Axisφ2.35)

Tumbler

Quick and easy way to polish



This tumbler use magnetic power to rotate steel burning shot inside of the tank. It is very convenient to polish fired work has narrow gap or detailed syringe work where burnisher cannot reach.

F-1144
Magnetic finishing tumbler
Tornado 100 V
 ※Japanese plug type.
Requires step down transformer.



Before



After



Put stainless steel shot about 50~70g in the tank. Putting too much shots will decrease polishing quality.



Pour 1/3 of water in the tank.



Put a small amount of liquid type burnishing compound. ※You can use neutral detergent as well.

Polishing materials



F-0107 Stainless steel burnishing shot

Net / 140g
 Material / Stainless steel 2 types of pins

Dilute it 50 - 100 times with water



F-1971 Liquid type Burnishing compound

100ml



F-0169 Stainless steel ball

Net / 100g
 Material / Stainless steel 1.2φ

You can make almost mirror finish by mixing 30% of stainless steel ball against 70% of stainless steel shot (In weight ratio). They also help to tighten (harden) the metal.

Clean stainless steel burnishing shot



To clean the burnishing shot, add a tablespoon of powder type burnishing compound in dirty burnishing shot with 200ml of water in the tank. Turn on the tumbler for 20-30 mins.

F-1146 Powder type burnishing compound

Net / 20g



Before



After

Dust protection

Safe, Clean, compact when using a rotary tool.



F-0110R Safety box for micro motors

Material / Chloroethylene plastic
 Size / W 200xL 200x H190mm



Work easily by placing your wrists on the rests



No more flying dust.

How to assemble

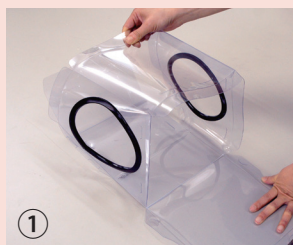

①

Open the top and bottom and stand the main box.

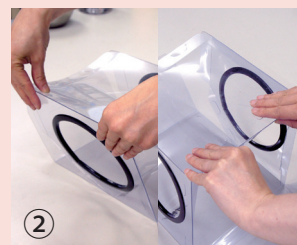

②

Fold all of the corners inside along scoring.



③

Close the bottom and insert the nails.

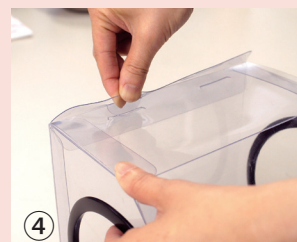

④

Same as step 3. Lock other nails to close the box.