



# Leaf Charm

Clay is easy to be textured, because of its softness !  
Try with your favourite leaf



For proper use, please read the instruction sheet of Art Clay and Stainless steel net for gas stove.



**Handle fire with care**

## Materials and tools

- Art Clay Silver 5g~7g
- Your favourite Leaf
- Baking sheet
- Water
- Straw (Narrow type)
- Hair dryer
- Tweezer
- Sponge sanding pad (red)
- Pencil
- Needle
- Stainless steel brush
- Chain or rope
- Stainless steel net for gas stove



1

Roll Art Clay type flat, whose size is enough to fit your leaf.

※Roll it on baking sheet.



2

Place a leaf on the clay. The side has clear vein should touch the clay. ※Moisten clay time to time to avoid clay from drying up.



3

Puch the leaf softly on the clay to transfer.

※If you would like to make the surface flat, you could push with a ruler.

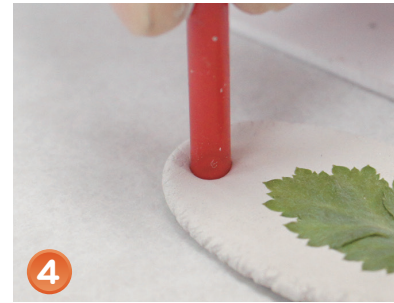

4

Make a hole with a straw and dry it for 15mins.

This hole is used to through a finding for chain.

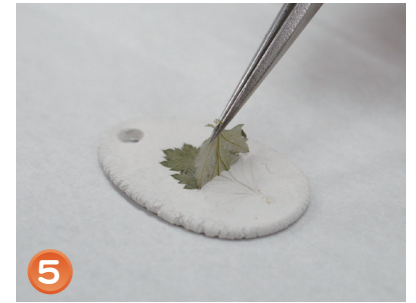

5

After the clay dried, take the leaf out with a tweezer. Or you can leave the leaf as it is.



6

Smooth the surface with a sponge sanding pad. (Red)



7

Adding message or initial, you write a draft with pencil and engrave with something sharp such as needle. ※Try not to use much tension, it break or causing crack of clay.

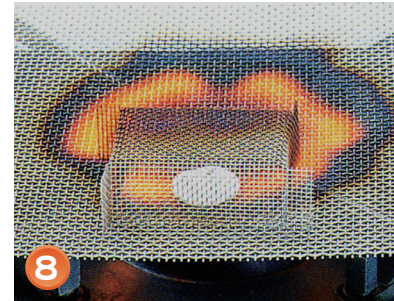

8

Fire with gas stove for 5 mins.

※Please read instruction sheet how to fire Art Clay.



9

After firing, polish it with a stainless steel brush.



10

Attach your favourite finding or chain.