



Textured Ring

Material:

Art Clay Silver 650 (Slow Dry) 7g or 10g x 1pc

Tools:

ACS Exclusive Work mat (or Cooking sheet), Wooden mandrel, Self-adhesive memo paper, Masking tape, Craft knife, Royal silver bezel (Medium), Spatula, Medium fine file, Rubber block, Sanding paper (#320), Sponge sanding pad (Red & Green), Stainless steel brush, Burnisher, Silver cloth, Silver polish

Easy project sheet for intro workshop!

Featuring the Top 3 most popular projects at Art Clay studios in Tokyo!

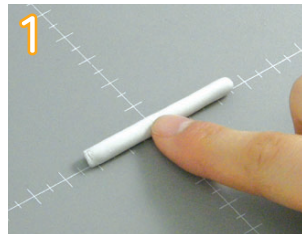

1 Use 10g clay, and make a rope 6,7mm thick.
*7g is enough for any ring sizes smaller than #10 or a thin ring design.



2 Wrap the self-adhesive memo around the wooden mandrel 3 sizes (1 size in the U.S.) larger than the desired size. Moisten the clay surface, and press one end on the mandrel. Cut the end diagonally with a craft knife.



3 Wrap the clay around the wooden mandrel, and cut the other end diagonally so as to attach the 2 ends together.

Check Point1

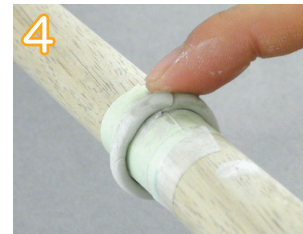

4 Apply a little bit of water to smooth the gap.



5 Press the surface to make a flat type ring.
*Do not press too hard, otherwise the ring will be too thin.



6 Roll the wooden mandrel on the work mat (or cooking sheet) to flatten out the ring.

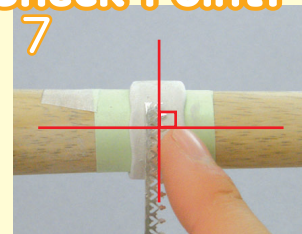

7 Place the Royal silver bezel front side down on the ring surface vertically, and press.

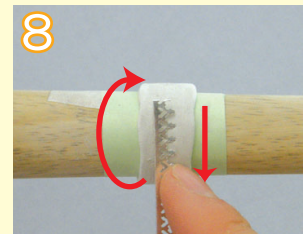

8 Turn the wooden mandrel to transfer the pattern of the bezel.

Check Point2



9 ※1 If the ring surface is too moist, the pattern will not be transferred well. The best condition is if the clay does not stick to your finger when you touch it.
※2 If the ring surface is too dry, it also will not transfer well. Use a wet tissue to give some moisture until the ring becomes the ideal shape, and work on it.
※2 Make sure to press the bezel into the clay until the bezel is buried.



Check Point3



10 Make sure the end of the pattern matches where it connects.



11 Use a spatula to trim the ring edges.



12 File the ring edges flat with a medium fine file, and sanding paper (#320).



13 Smooth the surface with a sponge sanding pad (Red/#320-600), and fire.



14 After firing, apply a stainless steel brush and a burnisher to partially shine.



15 Use a sponge sanding pad (Green/#1200-1500) to remove any scratches from burnishing, and polish the ring with a silver cloth to complete.



Ranking **1st**

Spiral Ring

The spiral ring project includes some synthetic stones, and looks very delicate with lots of detail, so this item is most popular at our workshops. The selection of stones and the beautiful open work with syringe will bring out the student's satisfaction.

Ranking **2nd**

Rose Pendant

The Rose pendant is the most popular among the flower motif projects. The process of making each petal and assembling them one by one gives you great satisfaction after finishing.



Ranking **3rd**

Textured Ring

A simple texturing process is included in this project. Using the Royal Silver bezel makes it easier to complete and gives the student satisfaction with a high quality result.



Spiral Ring



Material:
Art Clay Silver 650 Syringe Type 5g x 1pc, Gray Nozzle, Art Clay Silver 650 Paste Type, Synthetic Gemstones/Cabochon 3φ/Aquamarine

Tools:
Self-adhesive memo paper, Ruler, Pencil, Wooden mandrel, Masking tape, Tweezers, Dryer, Paint brush (Small), Wet tissue, Stainless steel brush, Burnisher, Silver cloth, Silver polish

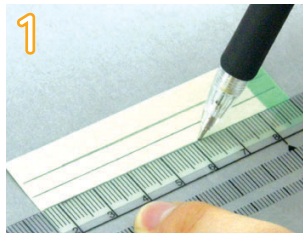

1 Draw 3 lines on the self-adhesive memo paper. One in the middle, the others on top and bottom which will be the width of ring.
※8-10mm between the lines.

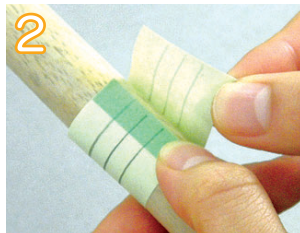

2 Wrap the self-adhesive memo paper around the wooden mandrel.
※Make a ring in 3 sizes (1 size in the U.S.) larger than the desired size.

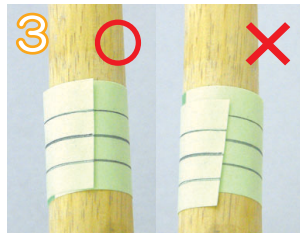

3 Make sure the lines match before commencing.



4 Use syringe type with a gray nozzle to make double lines for the sides of the ring. If you extrude 2-3 cm of syringe first, and then wrap it around the mandrel, it will be easier.

CheckPoint1



5 For making the ring stronger, apply syringe lines at an angle between the sides.

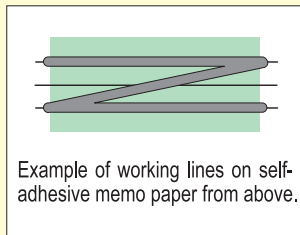

Example of working lines on self-adhesive memo paper from above.



6 Draw syringe lines randomly. Make sure these lines attach to the edges so that the ring has more strength.

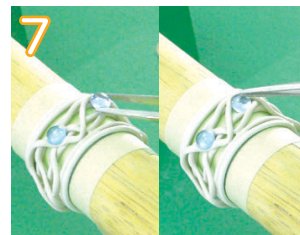

7 Place the synthetic stones between the lines, and adjust the stone's faces to sit straight with tweezers.

CheckPoint2



8 Draw syringe lines in a zigzag pattern to touch the edge of the stones.



9 Make sure to work from both sides to surround the stones securely.

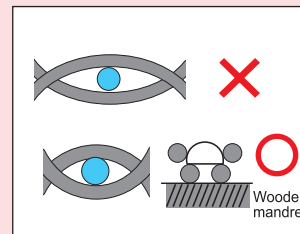

If the stone is not surrounded by the syringe lines properly, the stone may come off after firing.



10 Dry the piece on the wooden mandrel, then remove from the wooden mandrel carefully and dry further, so as to dry the inside of the ring completely.



11 Hold the memo paper with tweezers to roll it off carefully.
※If the piece is not dry enough, it may break.



12 If the ring has any rough areas on the edges, use wet tissue to carefully wipe and smooth.



13 Apply Art Clay Paste type between some of the gaps, working from the inside. Do half the ring at a time, then dry completely.
※If you apply Paste type all around the ring at once, the ring may collapse because of the moisture of the paste type.



14 After firing, apply a stainless steel brush, and polish the ring with a silver cloth and a burnisher to complete.

Rose Pendant



Material:
Art Clay Silver 650 (Slow Dry) 5g x 1pc, Art Clay Silver 650 Paste Type, Fine Silver flat screw eye x 1pc

Tools:
Cooking sheet, Medium fine file, Rubber block, Paint brush (Small), Sponge sanding pad (Red), Stainless steel brush, Burnisher, Silver cloth, Silver polish

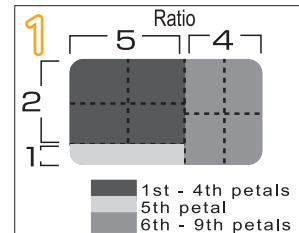

1 Cut 5g clay into 9 pieces. Make sure to keep the unused clay portion moist in some plastic wrap.



2 Make 3 mm ball for the 1st petal (core).



3 Roll it out with your fingers as in the picture. Leave the joint part of the petal thick, and make it thinner towards the edge.



4 Wrap the clay into a cone shape to make a core part. Make the bottom part thinner.

CheckPoint1



5 Apply a little water around the core, and attach the 2nd petal as you make in step 3 against the core.



6 Make sure to join the petals together at the base, and curl the edge part outward.



7 Repeat the same process for the 3rd & 4th petals to surround the core like shown the picture.

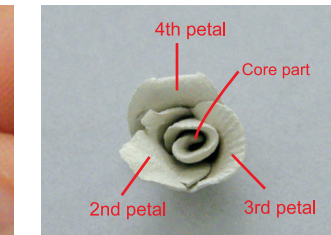

CheckPoint2

CheckPoint3



8 For the 5th to 9th petals, roll out the clay in oval shape with even thickness.

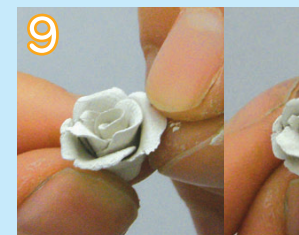

9 Apply a little water, and attach the rest of the petals. Curl the edge part of the petals outward to fix the shape. Surround the core with the 5th -9th petals like the picture.

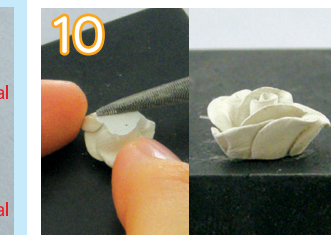
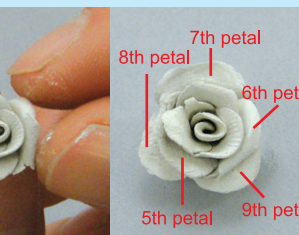

10 Use a medium fine file to make the bottom of the rose flat.



11 Attach the flat screw eye on the back with paste type, and dry the piece.
※If there are any gaps in the back, fill them with Paste Type.



12 Smooth the surface with a sponge sanding pad (Red/#320-600), and fire the piece.



13 Apply a stainless steel brush to finish the entire piece and a burnisher for the top part of the petals.



14 Polish with a silver cloth containing a little bit of silver polish to complete.